

Townhouse in Pedregalejo

More info:

The UNIQUE project offers a total of 11 luxury semi-detached single-family homes, ranging in size from 260m² to 360m². These homes are located in an exclusive complex and feature exceptional characteristics, such as unique private patios and spacious terraces. The concept of 'patio houses' has been carefully applied in the design of these homes, meaning that the various rooms are arranged around a covered interior courtyard. This space is versatile and filled with light, maki...

Price: **995.000 €**

Bedrooms: 3

Bathrooms: 2

Built: 170m²

Plot:

Terrace: 68m²

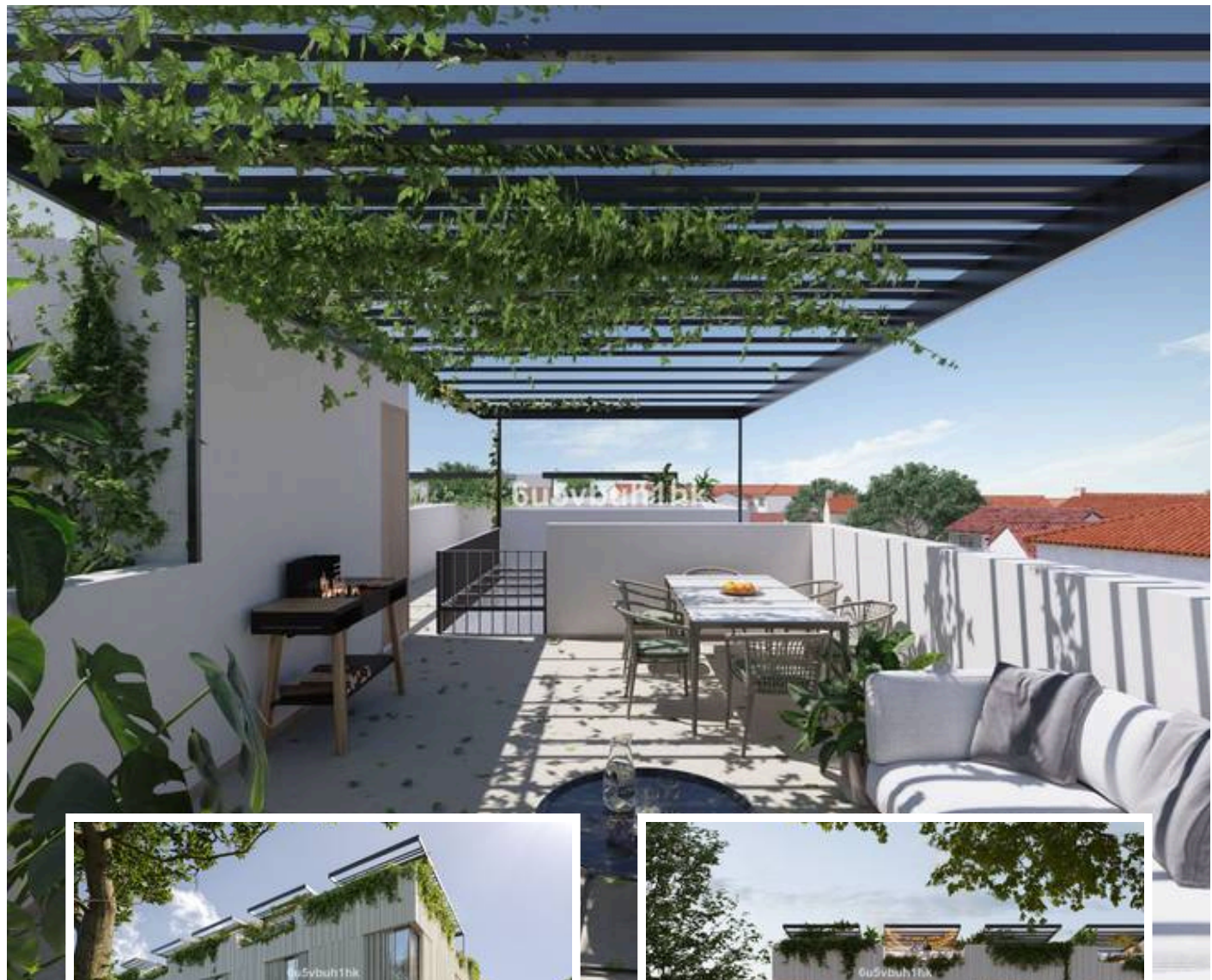

Marbella

info@bestliving.es

+34 747 471 108