



Description

Welcome to this attractive penthouse in Benalmádena Costa, with tourist license, ideally located just 500 meters from the beach and approximately 2 kilometers from the charming Benalmádena Marina, Puerto Marina. The property enjoys a prime location within walking distance to restaurants, shops, cafés, and all amenities, making it ideal as a permanent residence, holiday home, or investment.

The apartment is distributed over two levels with a well-planned layout. On the entrance level, you are welcomed by an open-plan kitchen and living area, creating a bright and social living space. This floor also features a cozy southwest-facing balcony, perfect for enjoying the evening sun, as well as two bedrooms and one bathroom.

Upstairs, you will find a spacious master bedroom with an en-suite bathroom. The current owners have converted part of the bedroom into a storage room, which also has a window and can easily be used as an additional bedroom, offic...





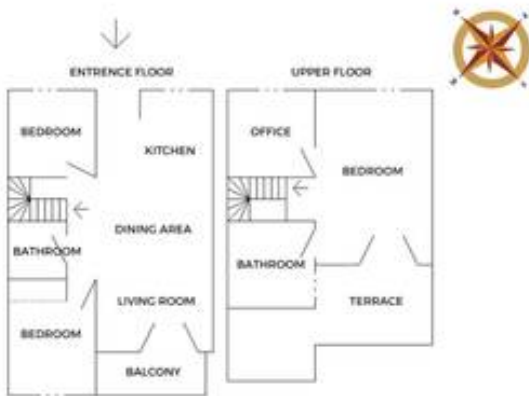

Measurements were taken on site with a CLM 50-27 CG PROFESSIONAL. Adjustments were done during drafting and not based on final measurements.