



Description

Technology Park, Campanillas, building

Building located in the area of the Technology Park, Campanillas!

Building of 2,500m² of land area, with a constructed area of 2332.14 m² and 2,078 m² useful distributed in 5 floors: basement, semi-basement, ground floor, first floor and second floor.

Basement: it has a garage area with 171 m², 3 rooms and 2 hallways.

Semi-basement floor: Work area with an area of 283 m² approx, 2 offices, switchboard, 2 toilets and lobby.

Ground Floor: entrance hall, 3 offices, 2 rooms, 2 toilets and 1 lobby.

First floor: Lobby, distributor, 3 rooms, 8 offices and 1 toilet.

Second floor: Lobby, 7 offices, 5 toilets and meeting room.

Features and equipment:

GROUND SURFACE: 2,500 m²

SURFACE BUILT: 2,332.14 m²...



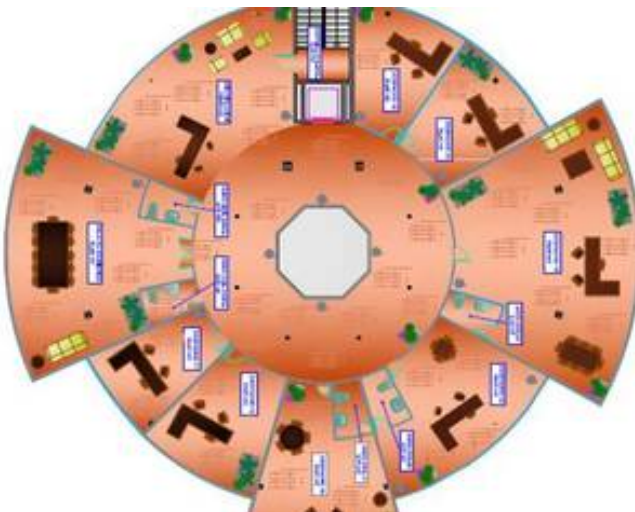
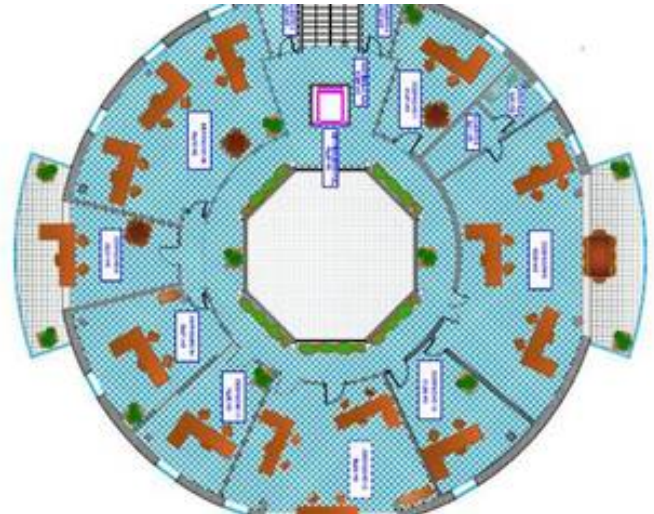

VESTIBULO P.S.1	19,23	-----
VESTIBULO P.S.2	4,57	-----
	394,82	438,25

PLANTA SEMISOTANO

PUESTOS DE TRABAJO	283,06	-----
DESPACHO 1	39,86	-----
DESPACHO 2	15,68	-----
CUARTO 1	8,90	-----
CENTRALITA	11,55	-----
ASEO CAB.P.S.S.	7,28	-----
ASEO SIN P.S.S.	7,78	-----
VESTIBULO P.S.S.	26,24	-----
	400,74	451,12

PLANTA BAJA

DESPACHO 3	121,32	-----
DESPACHO 4	85,69	-----
DESPACHO 5	13,19	-----
CUARTO 2	2,08	-----
CUARTO 3	2,08	-----
HALL DE ENTRADA	199,42	-----
ASEO CAB.P.B.	9,33	-----
ASEO SIN.P.B.	9,33	-----
VESTIBULO P.B.	7,09	-----
	456,13	467,91

DESPACHO 10	24,51	-----
DESPACHO 11	19,38	-----
DESPACHO 12	56,83	-----
DESPACHO 13	21,99	-----
CUARTO 4	3,57	-----
CUARTO 5	3,57	-----
CUARTO 6	5,11	-----
VESTIBULO P.P.	12,66	-----
DISTRIBUIDOR P.P.	49,60	-----
ASEO 1	4,64	-----
	387,82	443,58

PLANTA SEGUNDA

DESPACHO 14	80,86	-----
DESPACHO 15	23,34	-----
DESPACHO 16	23,68	-----
DESPACHO 17	18,43	-----
DESPACHO 18	24,54	-----
DESPACHO 19	42,61	-----
DESPACHO 20	35,00	-----
SALA DE REUNIONES	61,98	-----
DISTRIBUCION	146,95	-----
ASEO DES.14	3,79	-----
ASEO DES.19	3,75	-----
ASEO DES.20	3,78	-----
ASEO CAB.P.SEG.	3,78	-----
ASEO SIN.P.SEG.	3,78	-----